

KEGELRÄDER AUS KUNSTSTOFF

Kunststoff gespritzt Moulée par injection Injection moulded
Quality I2

ROUES CORNIQUES EN PLASTIQUES BEVEL GEARS IN PLASTIC

Kegelräder Kunststoff, gespritzt	Plastique moulée par injection	Plastic injection moulded
Material: Hostaform C	Matière: Hostaform C	Material: Hostaform C
Zahnung: gerade verzahnt	Denture: denture droite	Teeth: straight teeth
Qualität: I2	Qualité: I2	Quality: I2

Ratio	Modul	Z	B _{H7}	N	D	H	L	F	A	Z	Kunststoff
											En mat. plast.
											Plastic
											Part No.
1:1	0.5	16	3	7	8.7	6	8	8	10.5	2	KH 0516
	1.0	16	5	12	17.6	8	13.6	13.6	18.4	4.7	KH 1016
	1.0	30	6	15	31.4	7.5	12.9	15.3	24.8	7.2	KH 1030
	1.5	16	8	18.5	26.4	10	16.2	18.4	25.8	7.0	KH 1516
	2.0	16	10	21.9	34.9	9.6	18.3	21.2	30.4	10.0	KH 2016
	2.5	16	12	25.2	43.5	11.5	22.9	25.5	37.0	12.3	KH 2516
	3.0	16	14	28.8	52.3	13.2	25.8	29.2	43.0	13.8	KH 3016
	3.5	16	18	33.3	61.4	14.4	28.1	33.1	49.5	15.8	KH 3516

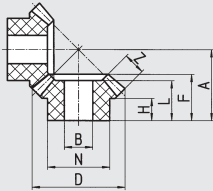

1:2	1.0	15	5	12.2	16.8			17	26.4	6.6	KH 101530
		30	8	18	31.1	9.1	14.8	16.2	20.9	6.6	
	1.5	15	8	17	25.4			22.8	35.8	10.5	KH 151530
		30	10	23.4	46.4	9.6	17.5	19.5	26.2	10.5	
	2.0	15	10	22.5	33.6		26	27	44.2	14.6	KH 201530
		30	12	30.2	62.2	11.8	22.6	24.2	32.6	14.6	
	2.5	15	12	26.5	42		29.6	31.2	53.3	17.3	KH 251530
		30	16	36.1	77.3	15	27.5	29.5	40.5	17.3	
	3.0	15	14	31.2	50.3		35	36.3	63.3	20.5	KH 301530
		30	18	45	93	19	34.2	37	49.5	20.5	

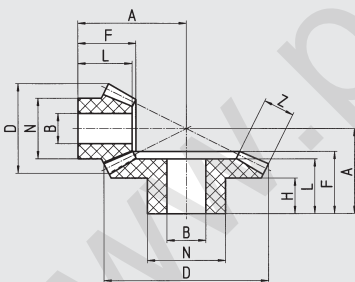

Kegelräder Kunststoff, gespritzt

Material: Hostaform C

Zahnung: geradeverzahnt
Qualität: 12

Plastique moulée par injection

Matière: Hostaform C

Denture: denture droite
Qualité: 12

Plastic injection moulded

Material: Hostaform C

Teeth: straight teeth
Quality: 12

Ratio	Modul	Zähnezahl No de dents No of teeth		N	D	H	L	F	A	Z	Kunststoff En mat. plast. Plastic Part No.
		Z	B _{H7}								
1:3	1.0	15	5	12.3	16.6			20.4	34.3	9.2	KH 101545
		45	10	23.4	46.1	9.6	16.5	18.2	22.7	9.2	
	1.5	15	8	17.2	25.1			26.8	47.9	14.0	KH 151545
		45	12	30.4	68.8	11.5	21.5	23.0	29.4	14.0	
	2.0	10	6	16.6	24.0			25.0	43.7	12.5	KH 201030
		30	12	30.3	61.7	11.5	20.2	22.5	28.0	12.5	
2.5	10	8	18.8	29.7			28.8	52.4	15.7	KH 251030	
	30	18	36.1	77.2	15.5	25.2	29.0	35.7	15.7		

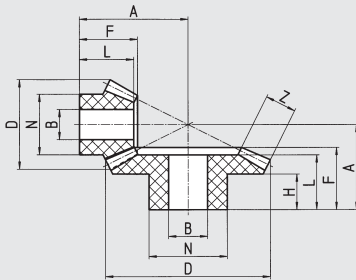

1:4

1.0	10	4	7.8	12.0				17.7	30.1	8.2	KH 101040
	40	10	23.4	40.8	10.8	15.7		17.0	20.1	8.2	
1.5	10	5	11.3	18.0				23.5	41.7	12.3	KH 151040
	40	12	30.4	61.2	12.8	20		21.7	26.2	12.3	
2.0	10	6	14.3	23.8				28.9	54.0	16.3	KH 201040
	40	18	36	81.5	16.6	24.7		27.0	32.5	16.3	

1:5

1.0	12	4	9.5	13.7				20.3	40.5	9.5	KH 101260
	60	10	20.5	60.4	11.0	15.5		17.4	21.0	9.5	